



FREEHOLD

House - Terraced

# LODGE AVENUE, DAGENHAM, RM8 2JP

Guide Price

# £350,000

## FEATURES

- TWO BEDROOMS
- GAS CENTRAL HEATING
- FITTED KITCHEN
- LOVELY WEST FACING GARDEN
- UPSTAIRS BATHROOM
- LOUNGE
- CONSERVATORY NEW SOLID ROOF
- COUNCIL TAX C



# 2 Bedroom House - Terraced located in Dagenham

## HALLWAY

Under stairs cupboard.

## LOUNGE

14 x 13

Bay window to front.

## KITCHEN

10 x 9

Fitted base, wall units, window and door leading to ....

## CONSERVATORY EXTENSION

16 x 9

With combi boiler, new solid roof, doors to garden.

## LANDING

Access to insulated loft.

## BEDROOM ONE

17 x 10

Window to front.

## BEDROOM TWO

10 x 8'6

Window overlooking open fields to rear, built in cupboard.

## SHOWER ROOM

Three piece suite, window to rear.

## EXTERIOR

Off road parking two cars, lovely west facing back garden, timber shed, lawn, patio, open sports field to rear.



DAGENHAM SALES | STEPS ESTATE AGENTS, 298 HEATHWAY, DAGENHAM, ESSEX, RM10 8LU

Call us on  
**020 8593 5933**

[dagenham@steps.me.uk](mailto:dagenham@steps.me.uk)  
[www.steps.me.uk](http://www.steps.me.uk)

Council Tax Band  
**C**

GROUND FLOOR



1ST FLOOR

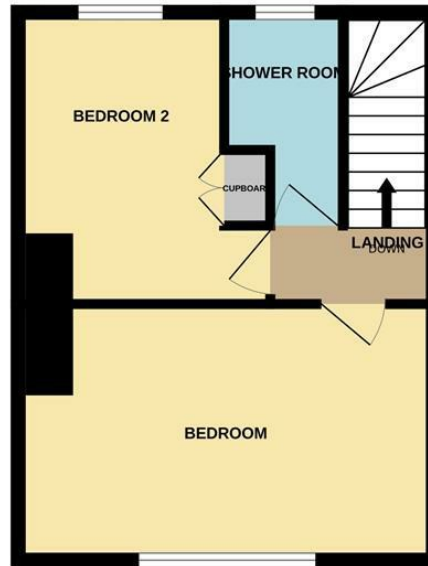

Whilst every attempt has been made to ensure the accuracy of the floorplan contained here, measurements of doors, windows, rooms and any other items are approximate and no responsibility is taken for any error, omission or mis-statement. This plan is for illustrative purposes only and should be used as such by any prospective purchaser. The services, systems and appliances shown have not been tested and no guarantee as to their operability or efficiency can be given.  
 Made with Metropix ©2025

Energy Efficiency Rating		Current	Potential
Very energy efficient - lower running costs			
(92 plus) <b>A</b>			85
(81-91) <b>B</b>			
(69-80) <b>C</b>			
(55-68) <b>D</b>		63	
(39-54) <b>E</b>			
(21-38) <b>F</b>			
(1-20) <b>G</b>			
Not energy efficient - higher running costs			
<b>England &amp; Wales</b>		EU Directive 2002/91/EC	

Agents Note: Whilst every care has been taken to prepare these particulars, they are for guidance purposes only. All measurements are approximate and are for general guidance purposes only and whilst every care has been taken to ensure their accuracy, they should not be relied upon and potential buyers are advised to recheck the measurements.

